

INSTALLATION

The device must be mounted away from the plasters, keeping a distance from the cover to allow the maintenance operations. The **Gas Filters** can be installed in any position as long as the arrow indicated on the **Gas Filter** body points towards the user. Use the tightening torques specified in the standard EN 13611 not by leveraging on the body.

REPLACEMENT OF THE CARTRIDGE

Before any operation of maintenance, you need to check that the valve installed before and after the **Gas Filter** are closed and the pressure are discharged with the drain plug.
Unscrew the screws of the cover, remove the cover, extract the cartridge e replace it with a new one, positioning as indicated inside the body.
Reassembly the body, and check that the cartridge comes inside correctly on the cover. Fix the screw with cross sequence.
Perform a leak test of the system.

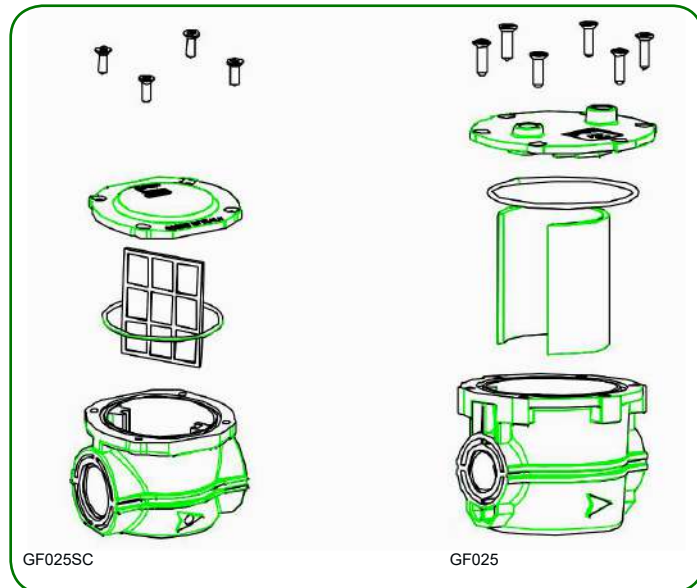

GAS FILTER SC (Small Capacity)

DIMENSIONS (mm) and WEIGHT (Kgs)

MOD.	mm			Kgs weight
	A	B	C	
GF015SC	72,0	60,0	65,0	0,221
GF020SC	72,0	60,0	65,0	0,212
GF025SC	72,0	60,0	65,0	0,199

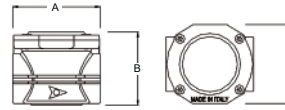

TECHNICAL FEATURES

Operation maximum pressure: 6bar or 10bar
Working Temperature: -20°C +80°C
Filtration: <50Micron
Use: Non-aggressive gases - Family 1-2-3 and air - Special version for Biogas
Cartridge: Plastic cartridge PP
Connection: Threaded gas 1/2" - 3/4" - 1" - ISO 228
Complete Body: Die - Cast aluminium Gd - AISI12Cu - EN AB 46100
Seals: NBR
Approval: 2014/68/UE (PED)
REGULATION (EU) 2016/426

FLOW CHART

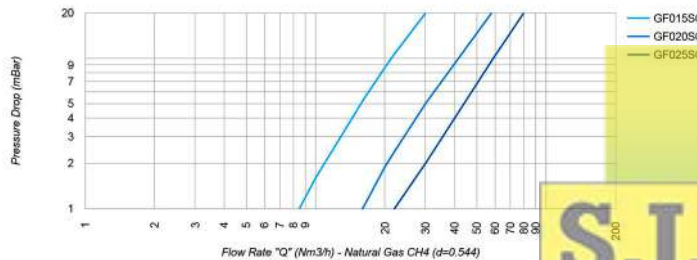

GAS FILTER

DIMENSIONS (mm) and WEIGHT (Kgs)

MOD.	mm				Kgs weight
	A	B	C	D	
GF015	114,0	105,5	118,5	63,0	0,80
GF020	114,0	105,5	118,5	63,0	0,79
GF025	114,0	105,5	118,5	63,0	0,78
GF032	164,0	131,5	152,5	82,0	2,05
GF040	164,0	131,5	152,5	82,0	2,00
GF050	164,0	131,5	152,5	82,0	1,90
GFD25	175,0	122,0	118,0	63,0	1,55
GFD32	269,0	158,0	158,0	82,0	3,55
GF040	269,0	163,0	163,0	82,0	3,65
GFD50	269,0	172,0	172,0	82,0	3,88
GF065	350,0	212,0	220,0	162,0	8,50
GFD80	350,0	212,0	220,0	162,0	8,00
GFD100	350,0	212,0	220,0	162,0	7,00
GFD125	442,5	347,5	330,0	303,5	23,0
GFD150	442,5	347,5	330,0	303,5	21,0
GFD200	600,0	370,5	445,0	445,0	61,5

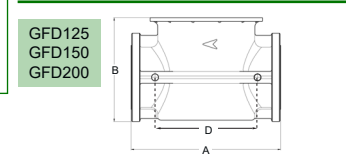
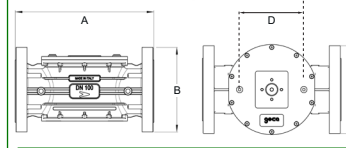
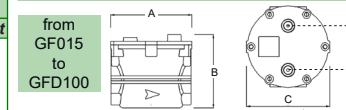

TECHNICAL FEATURES

Operation maximum pressure: 6bar or 10bar.
Working Temperature: -20°C 80°C.
Filtration: 50Micron.
Use: Non-aggressive gases - Family 1-2-3 and air. Viledon cartridge.
Cartridge element: Viledon cartridge.
Inlet-Outlet: Threaded gas 1/2" - 3/4" - 1" - 1 1/4" - 1 1/2" - 2" - ISO 228.
Connection: Sliding Aluminium flange PN10: DN25 - DN32-DN40 - DN50. Flanged PN16: DN65-DN80-DN100-DN125-DN150-DN200.
Die - Cast Aluminium Gd - AISI12Cu - EN AB 46100.
NBR.
Approval: 2014/68/UE (PED).
REGULATION (EU) 2016/426.

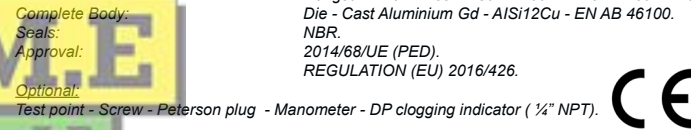

FLOW CHART

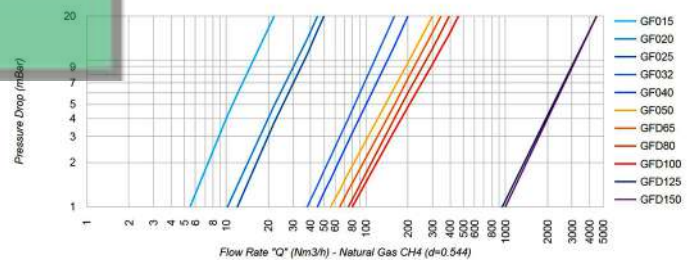

Directive 2012/19/UE (Waste Electrical and Electronic Equipment - WEEE):
Information for users:
The crossed out wheeled bin label that can be found on your product indicates that this product should not be disposed of via the normal household waste stream. To prevent possible harm to the environment or human health please separate this product from other waste streams to ensure that it can be recycled in an environmentally sound manner. For more details on available collection facilities please contact your local government office or the retailer where you purchased this product.

Tecnocentro
Tecnocentrol Srl
Via Miglioli, n°47 20090 Segrate (MI)
Italy Tel. +39 02 26922890
www.tecnocentrol.it

GECA Srl
Via E. Fermi, n°98 25064 Gussago (BS)
Italy Tel. +39 030 3730218
www.gecasrl.it

The manufacturer reserves the right make any aesthetic or functional change without notice and at any time.

Gas Filter



Italiano

6 - 10 bar



MADE IN ITALY



FILTRI GAS

GFD050-TPIO-10B



- 1 **GF=GAS FILTER**
- 2 **ATTACCHI:**
= Threaded
D= Flanged
- 3 **DIMENSIONI:**
015SC = 1/2" (Piccola capacità)
020SC = 3/4" (Piccola capacità)
025SC = 1" (Piccola capacità)
015 = 1/2"
020 = 3/4"
025 = 1"
25 = DN25
032 = 1 1/4"
32 = DN32
040 = 1 1/2"
40 = DN40
050 = 2"
50 = DN50
65 = DN65
80 = DN80
100 = DN100
125 = DN125
150 = DN150
200 = DN200
- 4 **OPTIONAL:**
SP= Screw Plugs
TPIO= Test Point IN/OUT
PP= PETERSON Plugs
- 5 **BAR:**
= 6bar
-10B = 10bar

DESCRIZIONE GENERALE

I **Gas Filter** sono progettati in conformità con le disposizioni della norma EN 12516 e DIN3840. Possono essere utilizzati per tutti i tipi di gas naturale, GPL o gas non corrosivi. Questi filtri sono ampiamente utilizzati per la protezione di dispositivi di controllo, regolatori di pressione contatori e su sistemi che richiedono un elevato grado di filtrazione. Tutti i coperchi dei **Gas Filter** sono muniti di attacchi per la verifica della pressione d'ingresso e d'uscita. Tutte le operazioni devono essere effettuate da personale tecnico specializzato.

ETICHETTA

I **Gas Filter** hanno riportato sul proprio corpo un'etichetta con le caratteristiche del modello:

GF015 1/2" P-max 6 bar
Filtration degree 50micron
S/N 000037/14 0497

GENERAL CONDITIONS OF WARRANTY
THE PRESENT CERTIFICATE IS THE ONLY DOCUMENT TO HAVE THE RIGHT OF REPARATION OF THE PRODUCT IN WARRANTY

- The product is warranted for 24 month from purchase date.
- Any damages caused by tampering and incorrect use or installation will be not covered by warranty.
- The warranty is valid only if it is full compiled.
- In case of defects covered by warranty, the producer will repair or replace the free product.

PERFORMANCES OUT OF WARRANTY:
When warranty's terms are spent, the eventual reparations will debited in according to the replaced parts and to the hand costs.

WARRANTY CERTIFICATE
TO COMPLETE AND SEND IN CASE OF DAMAGE

DEVICE: GAS FILTER SC mod. _____ GAS FILTER mod. _____
Serial number(s.n.) _____
DEALER _____
Stamp: _____ Date of purchase: _____

USER
Surname and name _____ n° _____
Address _____
City _____

Dis. 80340721 Cod. 95-2-12-15-064